



Hazel Drive, South Ockendon

Offers Over **£375,000** Freehold

SOLD

Ali & Co are delighted to present this Fantastic THREE BEDROOM SEMI DETACHED FAMILY HOME, Located on the ever popular development of BRANDON GROVES in South Ockendon.

Private Road | Tree Lined Esate | Close to schools | Close To Station | Close Proximity To Lakeside Shopping Centre | Close to Town Centre | Conservatory | Driveway | Garage | Cloakroom | Three Bedroom Home |

01375 806786

hello@aliandcoproperty.co.uk

Ali&Co
PROPERTY SERVICES

Stunning Three Bedroom House on a Private Road

Ali & Co are delighted to present this Fantastic THREE BEDROOM SEMI DETACHED FAMILY HOME, Located on the ever popular development of BRANDON GROVES in South Ockendon.

Welcome to this Three bedroom family home in a private road. in the popular neighbourhood of Brandon Groves.

0.7 mile away is South Ockendon Station C2C, local schools are within walking distance,

The Property is easily accessible to road links close by ,M25, A13 and is close to Lakeside Shopping Centre.

The property offer spacious, Modern accommodation, Hallway leading to a large lounge , Modern kitchen with separate dining room with Conservatory, leading to a landscaped rear garden with side access to the garage.

Ground floor WC, the property benefits from having three good size bedrooms and modern family bathroom.

There is a paved driveway to the front .

Internal viewing is highly recommended.

Council Tax Band: D (Thurrock Council)

Tenure: Freehold

Lounge

w: 3.8m x l: 4.36m x h: 2.2m (w: 12' 6" x l: 14' 4" x h: 7' 3")

Dining

w: 2.28m x l: 2.85m x h: 2.2m (w: 7' 6" x l: 9' 4" x h: 7' 3")

Kitchen

w: 2.45m x l: 2.85m x h: 2.2m (w: 8' x l: 9' 4" x h: 7' 3")

Conservatory

w: 2.28m x l: 2.28m (w: 7' 6" x l: 7' 6")

Bedroom 1

w: 2.78m x l: 3.98m x h: 2.2m (w: 9' 1" x l: 13' 1" x h: 7' 3")

Bedroom 2

w: 2.78m x l: 3.24m x h: 2.2m (w: 9' 1" x l: 10' 8" x h: 7' 3")

Bedroom 3

w: 1.94m x l: 2.35m x h: 2.2m (w: 6' 4" x l: 7' 9" x h: 7' 3")

Bathroom

w: 1.94m x l: 2.08m x h: 2.2m (w: 6' 4" x l: 6' 10" x h: 7' 3")





GROUND FLOOR
563 sq.ft. (52.3 sq.m.) approx.



1ST FLOOR
367 sq.ft. (34.1 sq.m.) approx.

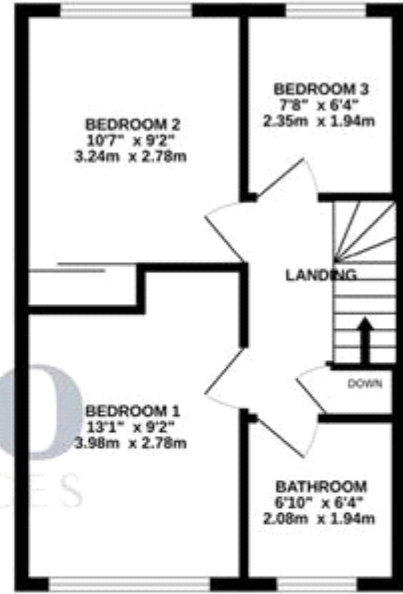

TOTAL FLOOR AREA : 930 sq.ft. (86.4 sq.m.) approx.

Whilst every attempt has been made to ensure the accuracy of the floorplan contained here, measurements of doors, windows, rooms and any other items are approximate and no responsibility is taken for any error, omission or mis-statement. This plan is for illustrative purposes only and should be used as such by any prospective purchaser. The services, systems and appliances shown have not been tested and no guarantee as to their operability or efficiency can be given.
Made with Metropix ©2024



Energy Efficiency Rating		
	Current	Potential
Very energy efficient - lower running costs		
(92-100) A		
(81-91) B		87
(69-80) C	69	
(55-68) D		
(39-54) E		
(21-38) F		
(1-20) G		
Not energy efficient - higher running costs		
England & Wales	EU Directive 2002/91/EC	

The energy efficiency rating is a measure of the overall efficiency of a home. The higher the rating the more energy efficient the home is and the lower the fuel bills will be.

Whilst every effort is made to ensure the accuracy of these details, it should be noted that the measurements are approximate only. Floorplans are for representation purposes only and prepared according to the RICS Code of Measuring Practice by our floorplan provider. Therefore, the layout of doors, windows and rooms are approximate and should be regarded as such by any prospective purchaser. Any internal photographs are intended as a guide only and it should not be assumed that any of the furniture/fittings are included in any sale. Where shown, details of lease, ground rent and service charge are provided by the vendor and their accuracy cannot be guaranteed, as the information may not have been verified and further checks should be made either through your solicitor/conveyance. Where appliances, including central heating, are mentioned, it cannot be assumed that they are in working order, as they have not been tested. Please also note that wiring, plumbing and drains have not been checked.